

CIMETIERE COMMUNAL DE HOCHSTATT

PLAN DES CONCESSIONS

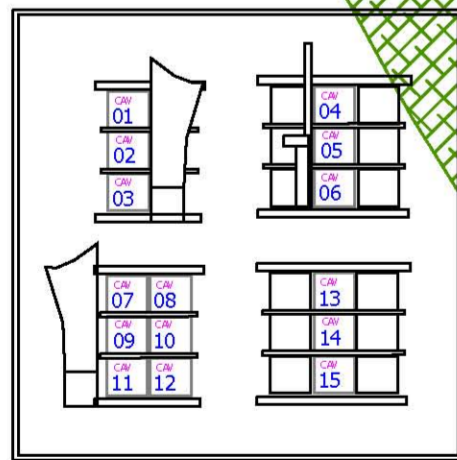

□ columbarium 1
□ columbarium 2



■ Emplacement vide
□ Tombe pierre 2.00 x 1.00 ou 2.00 x 2.00
□ Tombe Terre 2.00 x 1.00 ou 2.00 x 2.00

Echelle 1/150
10/05/08